

Through Beam Lightbarriers (Glass Fibre With Radial Light Output)

LLGE 2001

LLGE 2001 (2000 mm, lx = 10 mm)

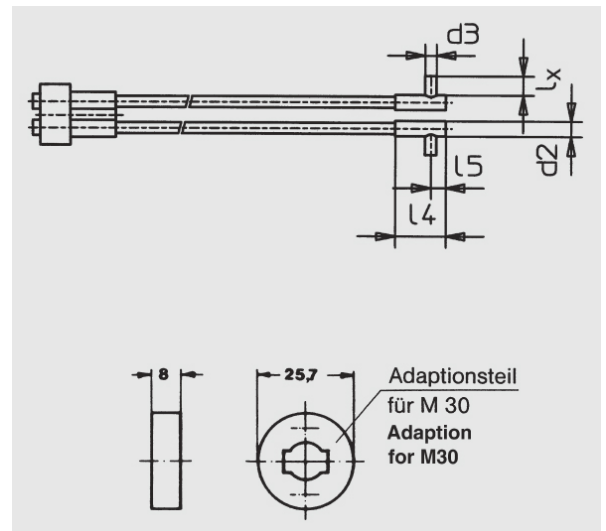

Glass slice pane:	12 mm ²
Length:	2000 mm, lx = 10 mm
Sn M18/M30:	2000 mm
Coating:	Aluminium

Further information about this product can be found on our website, please visit:

https://schoenbuch-sensor.de/en/products/llge-2001_en/