

Through Beam Lightbarriers (Glass Fibre With Radial Light Output)

# LLFE 2001

**LLFE 2001 (8000 mm, lx = 10 mm)**

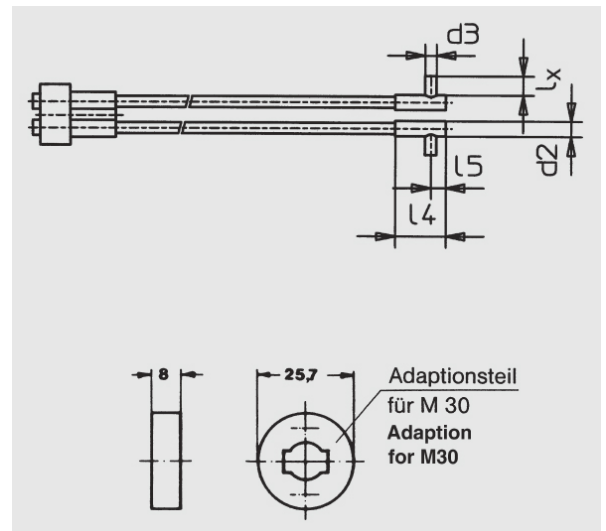

Glass slice pane:	4 mm <sup>2</sup>
Length:	8000 mm, lx = 10 mm
Sn M18/M30:	1000 mm
Coating:	Aluminium

Further information about this product can be found on our website, please visit:

[https://schoenbuch-sensor.de/en/products/llfe-1001\\_en/llfe-2001\\_en/](https://schoenbuch-sensor.de/en/products/llfe-1001_en/llfe-2001_en/)